

WCCTV

Third-Party Compliance Risks to Jobsites and How to Prevent Them

Third-Party Compliance Risks to Jobsites and How to Prevent Them

Construction sites face major compliance risks when third-party vendors and subcontractors operate with inconsistent safety standards or weak supervision, leaving site owners exposed to regulatory breaches, legal liabilities, and reputational damage. The article outlines practical ways to reduce these risks by strengthening oversight, improving monitoring, and modernising subcontractor and vendor management across all projects.



Understanding Your Responsibilities as the Project Owner

When your company is the General Contractor (or Principal) on a project, you assume the risks and liabilities that come with the job. As the controlling contractor, you are expected to:

- Ensure subcontractors follow safety and health requirements.
- Fix violations directly or require subcontractors to do so.
- Use reasonable care, including regular safety checks.
- Increase oversight if a subcontractor has a non-compliance history.

7 Third-Party Risks on Jobsites Plus Prevention Strategies

Many compliance failures on jobsites arise from weak subcontractor supervision. Traditional risk management involves physical spot checks to ensure contracted parties comply with health and safety standards. But in large, busy environments, managing third-party risks manually is inadequate, and many critical gaps go undetected.

Here are 7 leading subcontractor compliance risk areas and monitoring approaches that help you to close the gaps.

- 1 Fire Hazards**
- 2 Vendor Sprawl**
- 3 PPE Non-Compliance**
- 4 Unsafe Work Practises**
- 5 Theft and Security Risks**
- 6 Environmental Violation Risks**
- 7 Unauthorised Access**



Fire Hazards

Negligent hot work or unsafe handling of combustible materials by subcontracted crews increases the risk of jobsite fires. Untrained subcontracted personnel working in multiple areas across the site can create several potential danger zones.



Mitigating the Risk:

- Smart detection systems like the specialized Smoke and Fire Detection cameras with AI analytics spot heat signatures and the faintest trail of smoke instantly, giving eyes across your entire site.

After identifying a threat, the system sends an immediate alert to your designated contact or responsible crew. The notification includes a timestamped snapshot, a video clip, and the precise location of the smoke or flames.

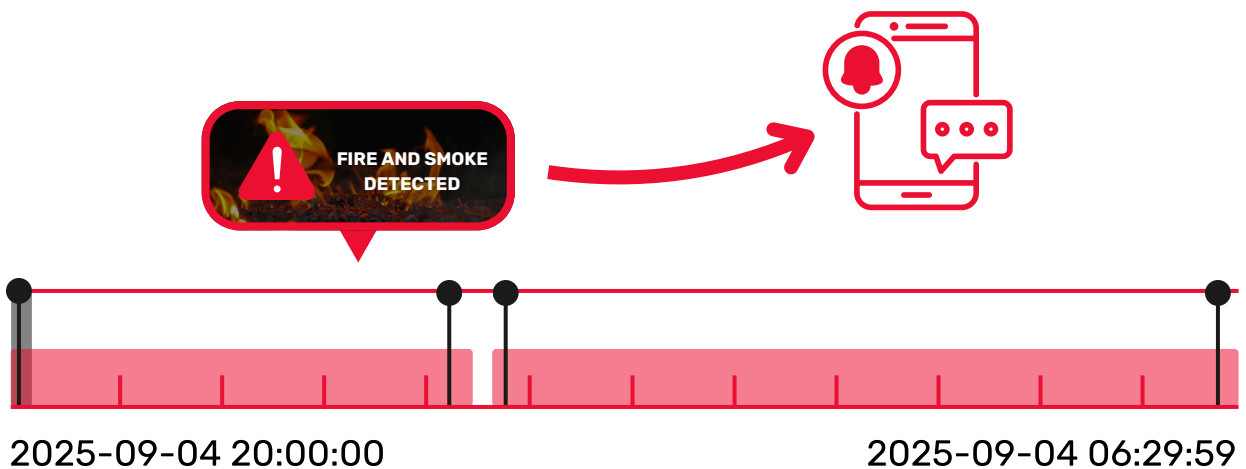

Vendor Sprawl

Construction managers often juggle five or more separate monitoring platforms, covering surveillance, environmental conditions, PPE compliance, incident reporting, and documentation, which creates a fragmented and time-consuming oversight process. With so much data spread across disconnected systems, the reliance on multiple third-party providers becomes a compliance risk in its own right, increasing the chances of missed alerts, inconsistent reporting, and gaps in accountability.



The Solution?

- As a centralized platform, Stellifii consolidates all security and compliance data, from perimeter breaches and air quality to PPE use, in one place. It provides a unified view that managers can access from anywhere with an internet connection.

Stellifii streamlines multi-vendor management and fully documents all safety activity, using AES-256 encryption to protect project data and meet CPRA and other data-protection standards.

PPE Non-Compliance

Although OSHA's PPE standards clearly require all employers to provide workers with proper protective equipment and enforce its use, a 2025 JJ Keller study found that 54% of construction leaders admit that inconsistent PPE wear remains a challenge on jobsites.

54%

This challenge is compounded when subcontractors fail to enforce appropriate PPE use (hard hats, high-visibility vests, safety harnesses, and protective goggles) among their crew.

How to Prevent the Risks:

- ➔ Closely monitoring third-party workers is key to reducing risks, and it requires more than occasional spot checks. AI-driven PPE detection systems track compliance across the jobsite and flag violations in real time, enabling immediate action, whether alerting the subcontractor or pausing work until proper gear is in place.
- ➔ Detection incidents can be logged to an all-in-one cloud-based system like Stellifii, our compliance management platform. This creates an objective record of the incident that you can address with the subcontractor and proves your due diligence to OSHA inspectors.



Unsafe Work Practises

Multiple subcontractors with varying safety standards and limited direct supervision introduce a range of dangers: fall risks from scaffolding, reckless handling of hazardous materials, unsafe access structures, dangerous equipment usage, and hot work without isolating nearby hazards.



How to Prevent the Risks:

- Pole-mounted or Temporary Cameras with intelligent monitoring software provide continuous visibility into activities across the jobsite. Equipped with infrared (IR) night vision and weather-resilient hardware, they detect unsafe practices, enabling your compliance team to intervene rapidly before serious harm or damage results.



Theft and Security Risks

Theft costs the construction industry billions in stolen assets and work disruptions every year. Avoiding theft and minor vandalism on projects with multiple subcontractors and (possibly) unvetted employees on site can be a challenge without proactive site security.



How to Prevent the Risks:

- A range of smart surveillance systems, including Intrusion Detection Solutions, protect high-value assets, metals, materials, and tools. Camera networks with AI analytics deliver the high-value, actionable insights you need to keep your jobsite secure and help leaders make better, faster security decisions and responses.

Environmental Violations

Under OSHA 1926.52 (Subpart D), which sets various noise limit rules, construction workers may not be exposed to noise levels exceeding 105 dBA for over 1 hour. Jobsite conditions must also comply with EPA thresholds under the Clean Air Act (CAA) and other environmental statutes. Negligent subcontractors often breach permitted environmental limits.



Mitigating the Risks:

IoT-based Environmental Monitoring Systems track environmental conditions against limits in real-time:

- Air Quality Sensors measure fine particulate matter (PM1, PM2.5, PM10) and trigger alerts when construction work nears thresholds.
- Noise Monitoring Devices record a wide decibel (30-130 dB) and frequency (20Hz-12.5kHz) range, helping to manage compliance with local standards.
- Weather Monitoring Stations track temperature, wind speed, humidity, and rainfall to help protect the jobsite and all contractors from extreme weather.



Unauthorised Access

Subcontractors and vehicles sometimes enter restricted or high-risk areas without permission, such as crane operations, demolition and excavation zones, and electrical rooms, whether due to a legitimate error or a disregard of jobsite rules.

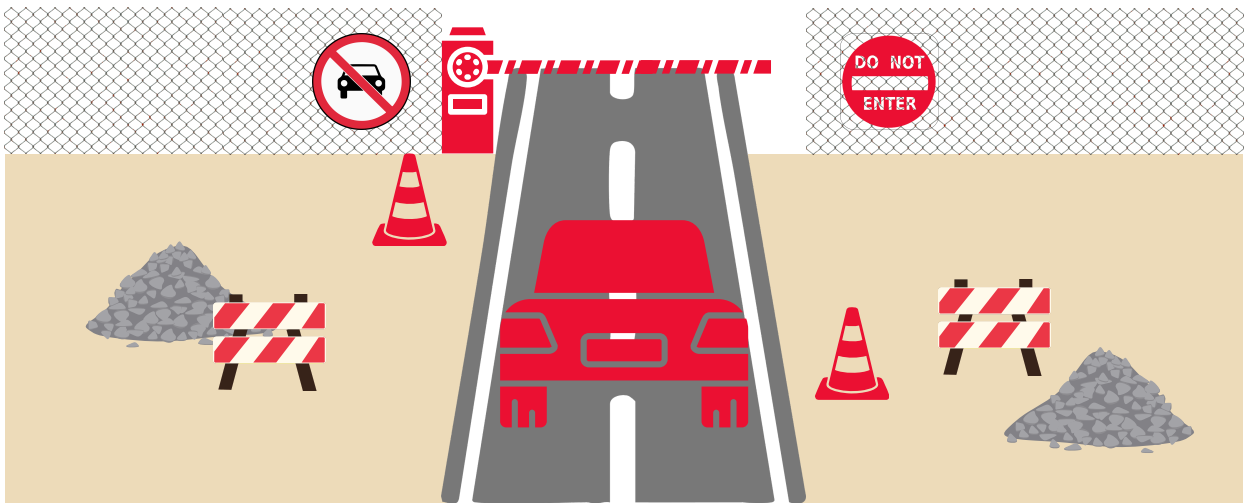

How to Prevent the Risks:

- Live Video Monitoring links your security system to 24/7 professional operators who can respond instantly to unsafe or unauthorised activity. Their interventions include: live voice warnings and strobe lights and dispatching a mobile security crew.
- Live monitoring reduces workplace risk and criminal trespass and encourages a stronger compliance culture.

How Digital Tools Enable Complete Oversight of Subcontractor Compliance

Construction firms are increasingly adopting comprehensive monitoring systems that combine smart digital tools into a single platform like Stellifii. This solution enables compliance leaders to enforce standards consistently across all external parties through:

- **Continuous monitoring and centralized visibility**
- **Automated reporting**
- **Real-time oversight**

Here's a high-level blueprint of how successful construction companies manage all their risk areas, including subcontractor compliance, across multiple projects:

Centralized Monitoring	Automated Reporting	Real-Time Oversight
PPE Monitoring: Tracks PPE compliance	Automated reports on PPE violations and corrective actions taken.	AI detects workers entering zones without the required equipment and immediately alerts a responsible contact; PPE compliance audits can be performed at any time.

How Digital Tools Enable Complete Oversight of Subcontractor Compliance

Centralized Monitoring	Automated Reporting	Real-Time Oversight
<p>Intrusion and Security Management: Ongoing monitoring for unauthorized access, breach, and theft attempts, and vehicle entries.</p>	<p>Reports summarize intrusions and security breaches, unauthorized vehicle logs, and security responses.</p>	<p>The system triggers real-time warnings to alert managers to breaches or if unauthorized personnel/vehicles enter restricted zones.</p>
<p>Live Video and License Plate Recognition (LPR): Dashboard integrates live video feeds and LPR logs.</p>	<p>Reports highlight suspicious and unsafe activity, unauthorized vehicles, and the frequency of incidents.</p>	<p>Live video monitoring can activate audio warnings or response teams to stop crime before it happens and address unsafe practices; LPR identifies and blocks unauthorized vehicles.</p>
<p>Environmental Monitoring: Sensor data on noise, air quality, and weather conditions.</p>	<p>Reports document environmental breaches and compliance actions.</p>	<p>AI cross-checks sensor triggers with video feeds to identify causes and sources and alert responsible teams.</p>

How Digital Tools Enable Complete Oversight of Subcontractor Compliance

Centralized Monitoring	Automated Reporting	Real-Time Oversight
Smoke and Fire Detection: Smoke/fire incident details.	Reports record fire/smoke incidents, response times, and mitigation actions.	Identifies smoke/fire indicators in video feeds and issues immediate alerts.

4 Additional Best Practices For Mitigating Third-Party Risks:

Monitoring helps, but pre-hire due diligence is essential. Here are four tips:

- 1 Standardised onboarding:** Gather safety docs, training records, certifications, and check references/compliance history.
- 2 Set clear expectations:** document safety standards and detail escalation steps.
- 3 Make compliance a contractual obligation:** Include measurable KPIs and defined consequences for compliance failures.
- 4 Benchmark against industry standards:** Ongoing monitoring of compliance performance against industry standards flags poor operators you need to address or terminate.

Contact Us

Wireless CCTV LLC
851 International Pkwy
Suite 140
Richardson, Texas
75081

T: 877 805 9475
E: sales@wcctv.com
E: service@wcctv.com

